

# ASK LoGO Development Kit

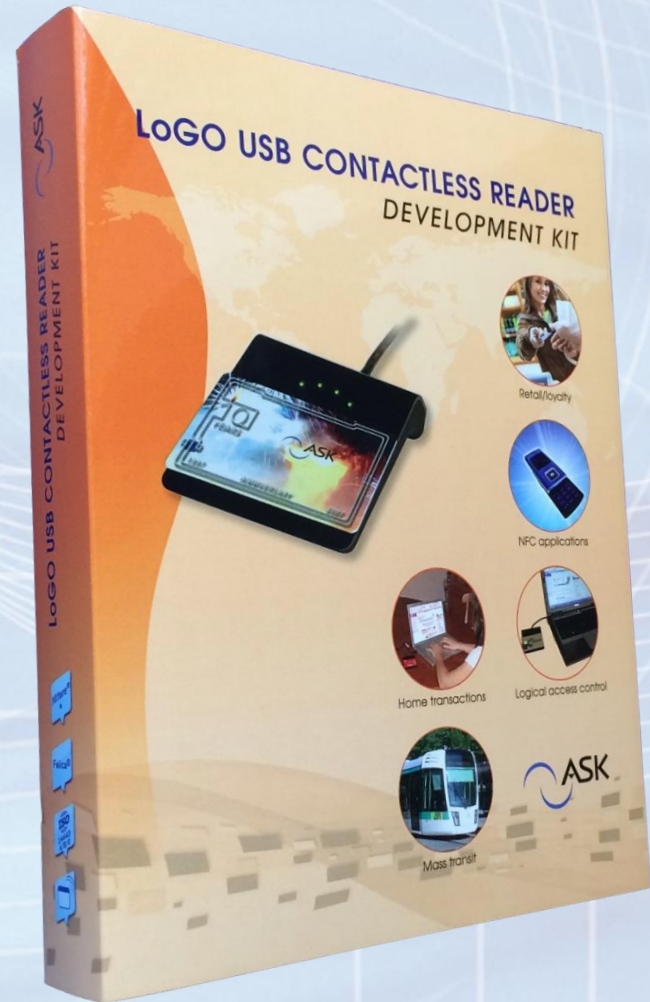

- Development kit content & description
- ASK LoGO functionalities & description
- Software and driver installation
- Media (USB flash drive) content

- 1 LoGO reader
- 1 Calypso GTML<sup>®</sup> and 1 Calypso GTML2<sup>®</sup> cards with test keys
- 1 Mifare Classic<sup>®</sup> 1K and 1 Mifare Plus<sup>®</sup> 2K cards
- 1 Mifare DESFire<sup>®</sup> 2K card
- 3 C.ticket<sup>®</sup> (SRT512, Mifare Ultralight<sup>®</sup>, Mifare Ultralight<sup>®</sup>C)
- 1 media (USB flash drive) containing drivers, applications, libraries and documentation
- 1 LoGO User Manual

# Development kit description

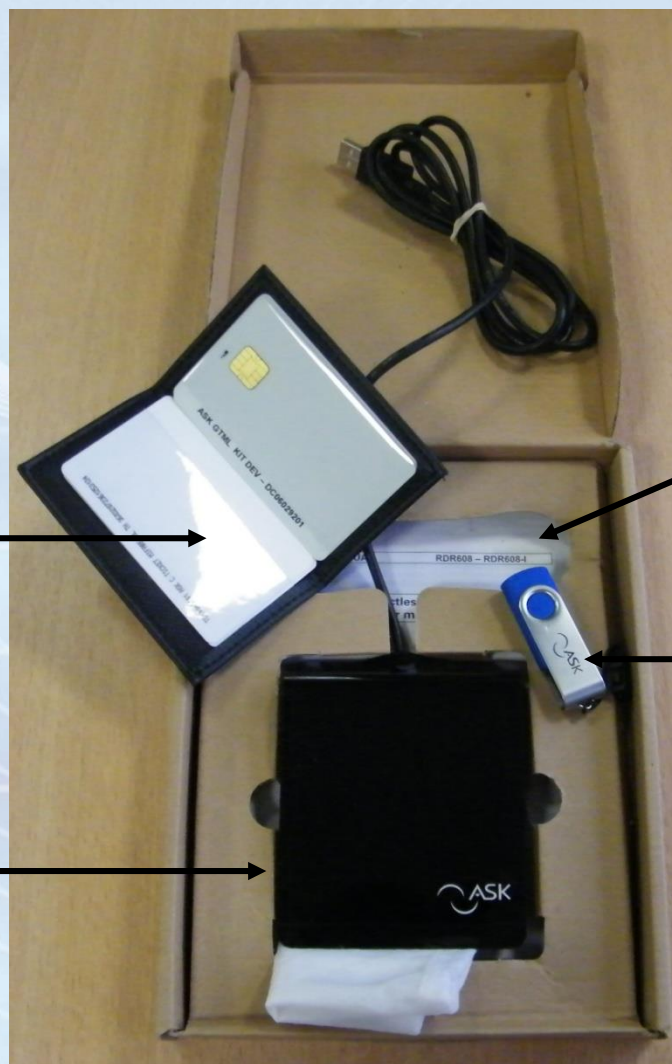

Cards and C.tickets® samples

User manual

Drivers, Applications, Libraries & Documentation on a USB flash drive

LoGO Reader

- ISO14443 A/B/B', Felica<sup>®</sup>, Mifare<sup>®</sup>
- High speed RF communication: 106 up to 848 Kb/s for ISOA/B, 212 up to 424 Kb/s for Felica<sup>®</sup>
- Cryptographic security with integrated Mifare<sup>®</sup> ASIC or external SAM
- USB2.0 full speed bus powered interface
- High power RF interface
- Windows PC/SC driver (WHQL certified)
- 4 signaling LEDs, user programmable

# LoGO description

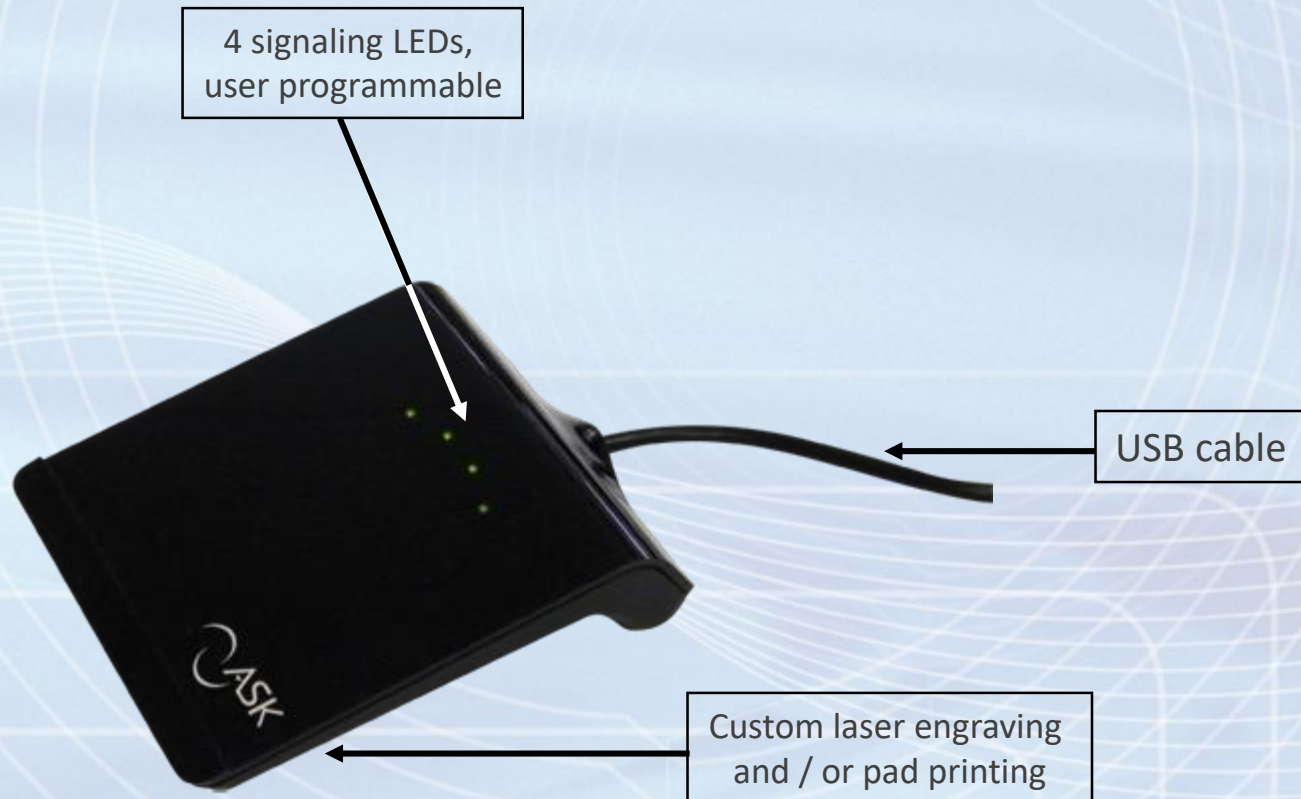

- Copy the USB flash drive content to a directory on your hard drive.
- Some applications and tools require standard “Setup”
- Evaluation applications are described in the document “RD-MU-09110\_xx\_LoGO Evaluation applications user manual.pdf”

- Uses the Windows standard process for driver installation or use «DriverInstaller.exe» or «DriverInstaller64.exe» utilities , from the «Drivers» directory.
- Described in the document “RD-MU-09106-XX\_RDR608\_LoGO\_UserManual.pdf”



- Documentation
  - User manuals (Reader & Software installation)
  - Technical specifications
- Software
  - Drivers, evaluation applications and utilities
  - Programming specifications with example source code

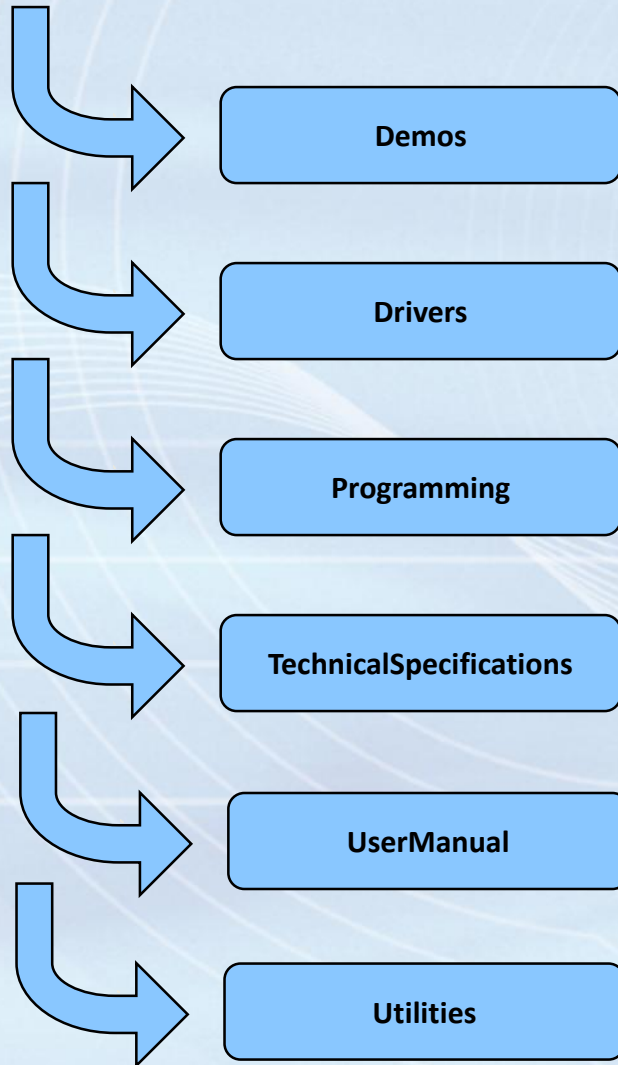

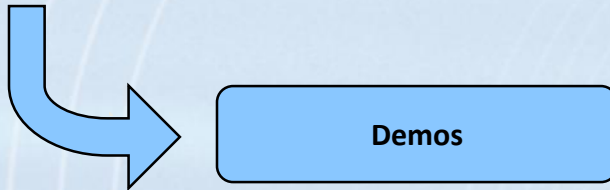

- Evaluation applications user manual
- LoGOPolling: card detection and identification
- ASKPCSC: PCSC utility
- ASK ePassport Viewer: display ICAO card contents
- Golden Reader: standard tool for ICAO cards

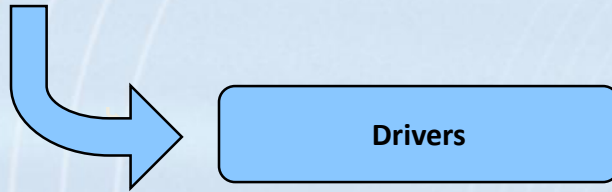

- Windows PC/SC driver (Microsoft WHQL certified)

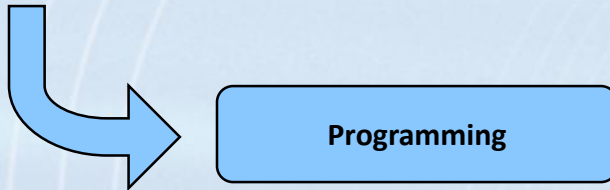

- Programming specifications
- Example source code using C
- Example source code using Java
- DESFire library: high level commands with integrated crypto (NXP<sup>®</sup> source)



TechnicalSpecifications

- LoGO technical specifications

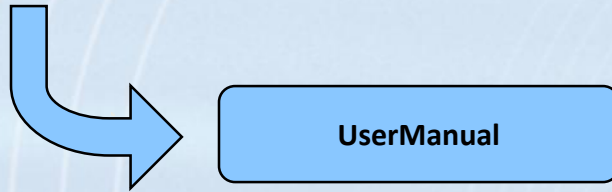

- LoGO user manuals



- PCSCKB: keyboard emulation for LoGO
- InitPCSCLoGO: allows the modification of the RF settings of LoGO  
(update for RDR608 with serial numbers lower than 1218XXXXXX)



Copyright 1997-2021 PARAGON ID

This document may not be shared with a third party without written authorization from a person approved by PARAGON ID.

Web: <https://www.paragon-id.com>

Support: <https://paragon-id.com/en/content/technical-support>